

NEEDLE VALVES

MODEL: **NDV**

BULLETIN: 505

Page 1 of 1

Needle valves are frequently used as metering valves. Metering valves are used for extremely Fine flow control.

Needle valves are used to adjust and protect delicate gauges from damage caused by sudden Pressure surges of liquids and gases.

CHARACTERISTICS

- Size 1/2"
- Material: Stainless Steel
- Brand: SSECO
- Pressure: 2000#

Operation and Mounting NDV

- 1) Pressure gauge (up to 16bar)

Needle valve, Rp 1/2" connection, Turn the valve handle for open/close positions.

- 2) R 1/2" connection nipple to gas line

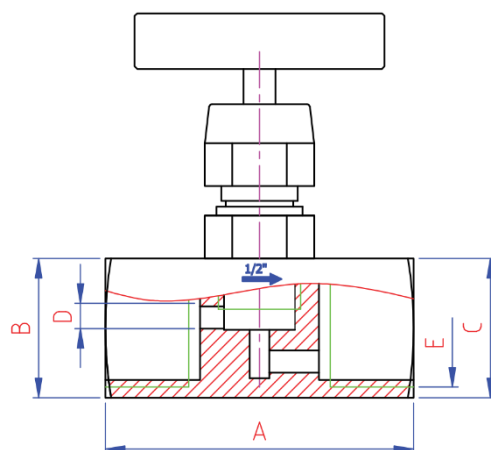

Model	Dimensions				
NDV-15	A (mm)	B (Ø)	C (mm)	D (mm)	E (inch)
	55.4	25	25	4	1/2

SHOLEH SANAT ENG. & MFG. CO.

MANUFACTURER OF BURNERS FOR FURNACES

FUEL CONVERSION OF BOILERS & FURNACES, DESIGN CONSULTATION AND INSTALLATION

REV.0 of 10th Oct. 2021